



SAIL TALL

BOUND FOR A NEW ADVENTURE





# WELCOME ABOARD

## THE FASCINATION OF A



An ocean voyage is more than salty air, fresh winds and the wide expanse of the open sky. It opens up the senses, is full of surprises, stimulates you and frees up your mind. Cast off, and soon all that is left of the world is the ship, the wide waters and the people on board. Time and space enough for lively conversation, fresh ideas, stimulating company and unforgettable experiences on the way to the horizon.

**Whether you are travelling on your own or planning an incentive trip for your staff:** Why not treat yourself and your partners to one of the numerous events and festivals? Sailing on our Tall Ships is always a perfect environment for all your corporate events and invitations.

**Business and pleasure really come together in the midst of the unparalleled match of a tallship** and the bounding main. Whatever your focus, we'll find a programme for it. Your customers can be part of an entire flotilla, a seagoing parade. Or let your employees learn to work as a crew in a match race against another windjammer! Stylish receptions under a starry sky, glittering parties in faraway ports and adventurous cruising: So many good contacts have had their beginnings in a relaxing atmosphere far away from everyday distractions.



# TALL SHIP

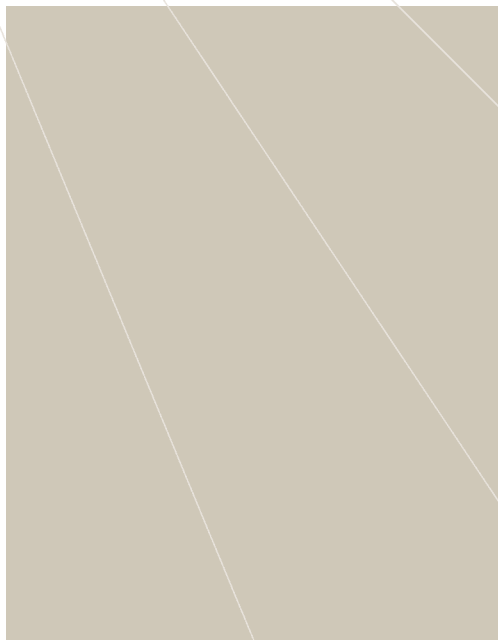
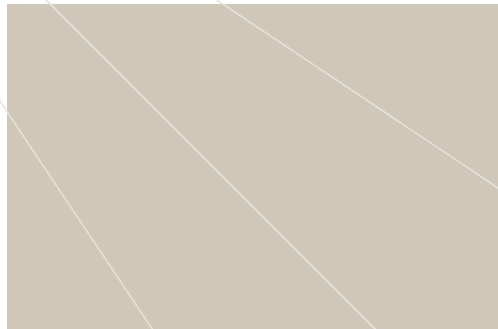



# STRAIGHTAWAY INTO THE WILD BLUE YONDER

**The beautiful sister ships Artemis, Atlantis and Antigua** are tallships with a long tradition. From the loving attention to detail evident in their furnishings to their tasteful ambience, they provide an exclusive location for special sailing voyages, whether private or business. Enjoy the unbeatable combination of traditional tallship and exclusive restaurant. The experienced crew will bring you to your destination safely, with attentive passenger service all the way. Our passengers are given the opportunity to haul on the hawser and sails and man the rudder themselves like sailors of old, just observe the professional crew at work on deck while they learn the principles of navigation, or just plain enjoy: beer on tap at the bar, sociable winetasting in the deck salon, a four-course dinner in the main salon or just a fresh fruit salad on deck. Our service crew knows just how to spoil you.

#### On-board facilities

Central heating and air conditioning · Fully equipped hotel kitchen with dish washer and large cold storage room · Bar with tap · Electric winches · Radar, satellite navigation, fax, email · Voltage on board: 380/230v, radio, CD player · Complete set of safety equipment, certification in accordance with the Dutch Shipping Inspectorate · Dingy with outboard motor



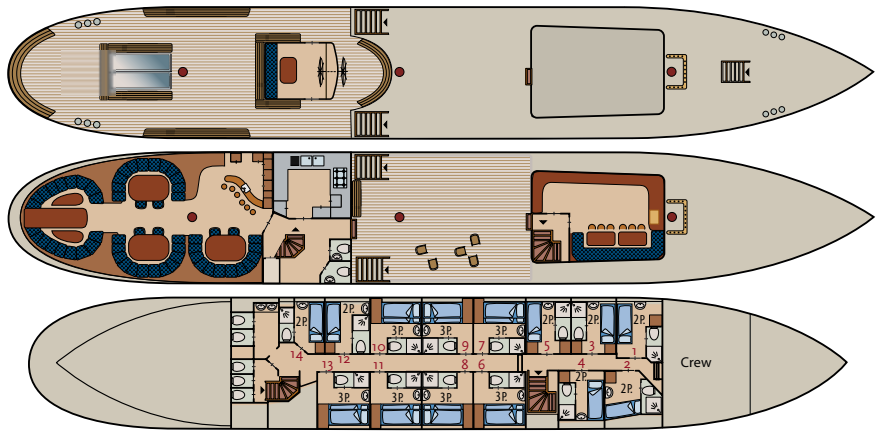

- overall length: 59,00 m
- beam: 7,01 m
- sail surface area: 1050 m<sup>2</sup>
- main engine: Caterpillar 550 PS
- bowthruster
- 2 x 40 kVA-generators
- safety certificate 9930Z

# ARTEMIS

Three-masted barque · up to 120 passengers on day trips · 14 cabins



## HISTORY OF THE ARTEMIS

She has her name from the goddess of the hunt, and it was as a whaler she began her career on the high seas. The ARTEMIS was built in Norway in 1926 and served as a whaling ship until the end of the forties, operating mainly in the northern and southern polar seas. From her home port of Oslo, she sailed to Spitsbergen (Svalbard) and into the Bering Sea, fitted with a steam engine, two auxiliary masts and a variety of harpoon guns. In the fifties, the ARTEMIS was refitted to haul cargo and operated mainly as a tramp freighter between Asia and South America until she was bought by a Danish captain from Marstal. Despite her ready seaworthiness, by the end of the nineties the ARTEMIS was too small to operate as a competitive freighter. She then changed hands again and was reconverted into an elegant sailing ship in 2001. The ARTEMIS now plies the seas in the form of an imposing three-masted barque.

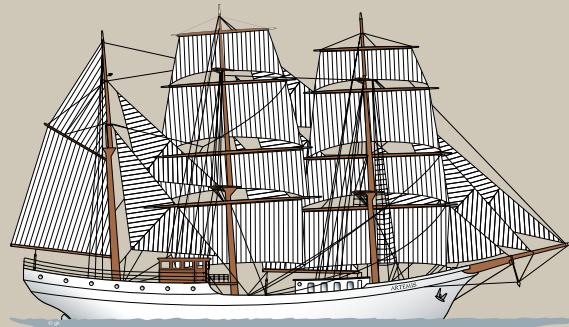

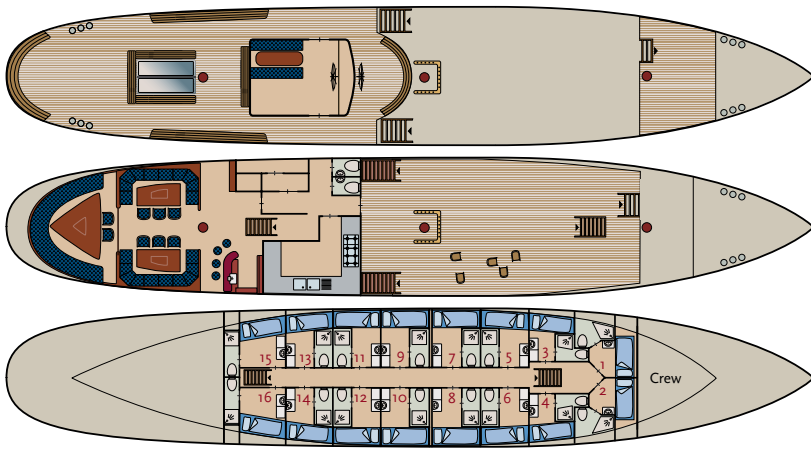

# ANTIGUA

Barquentine · up to 95 passengers on day trips · 16 cabins

- overall length: 49,50 m
- beam: 7,13 m
- sail surface area: 750 m<sup>2</sup>
- main engine: Cummins 400 PS
- bowthruster
- 1 x 65 kVA-generator and 1 x 35 kVA-generator
- safety certificate 9356Z

## HISTORY OF THE ANTIGUA

The ANTIGUA was built as a fishing vessel in Thorne, Yorkshire (U.K.) in 1957 and served her duty reliably over a period of many years. However, the fact that a sleeping beauty was hidden behind the tough work horse was only discovered many years later. The idea of converting the ANTIGUA into a barquentine and waking her from her deep sleep goes back to the beginning of the nineties. She was refitted with all the comforts of a modern tallship, involving an extensive and loving conversion. The metamorphosis from fishing vessel to elegant three-masted barquentine took place gently, in style and with a real sense of tradition. The ANTIGUA now plies the seas on adventurous voyages, just like her beautiful sister ships.

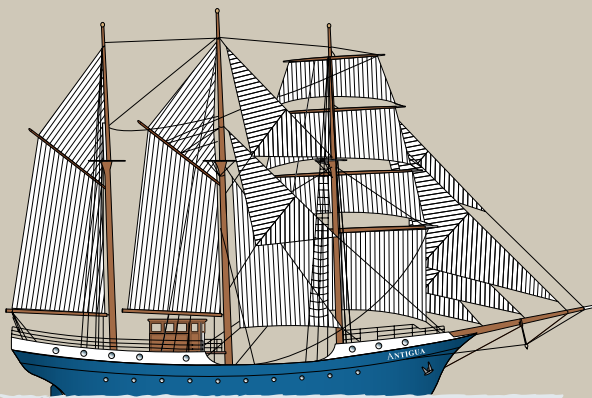

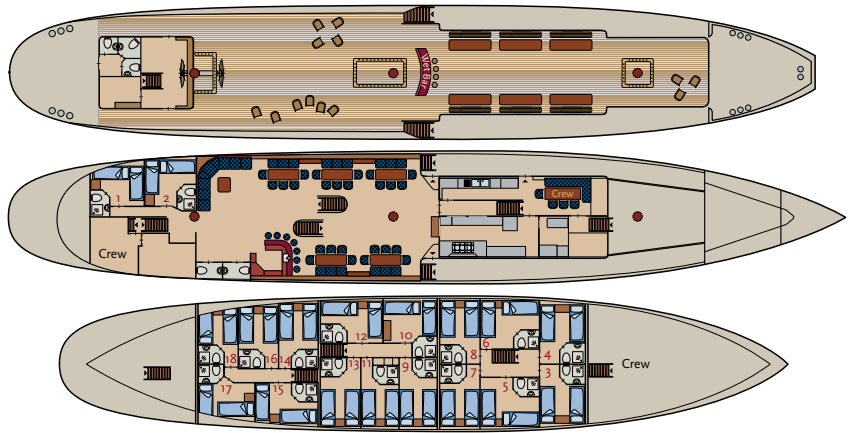

- overall length: 57,00 m
- beam: 7,45 m
- sail surface area: 750 qm
- main engine: Daewoo 750PS
- bowthruster
- 1 x 80 kVA-generator and 1 x 40 kVA-generator
- safety certificate 9603Z

# ATLANTIS

Barquentine · up to 140 passengers on day trips · 18 cabins



## HISTORY OF THE ATLANTIS

In the year 1905 a special ship was launched in Hamburg and took its position in the Elbe Estuary: the lightship ELBE 2. For more than 70 years it withstood all weather conditions until it was removed from service. As the ship's contour line resembles a sailing vessel a German owner could realize a dream in the early 80s: the ship was converted into an elegant three-masted barquentine and henceforth sailed with guests in Western Europe and the Caribbean under its new name ATLANTIS. In 2005 the square-rigger became a new owner. Now it was time for the ship to undergo a general refurbishment, while maintaining its unique, classy character. From 2006 on the ATLANTIS will again set sail to cruise also in the Mediterranean Sea.

